

# UBC Learning Commons Guides

## LCD Projectors

The LCD (liquid crystal displays) projector allows you to view media from external devices on a bigger screen.

**LOAN TIME: 1 DAY**

Fine Rate: \$5/day up to a max of \$30  
Replacement Value: \$400

Available to:  
- Students, Faculty, and Staff

**Bookable Item:**  
[libcal.library.ubc.ca/equipment/item/20082](http://libcal.library.ubc.ca/equipment/item/20082)

### Quick Start

#### Set Up

1. Turn on the computer (not pictured).
2. Plug the projector into the wall (Image A).
3. Open the projector's lens cover all the way (Image B).
4. Press the power button on the projector or remote control. The power light flashes green (or blue), then stays on (Image C).

**NOTE: To shut down the projector, press the power button twice, wait for 10 seconds, then unplug it.**

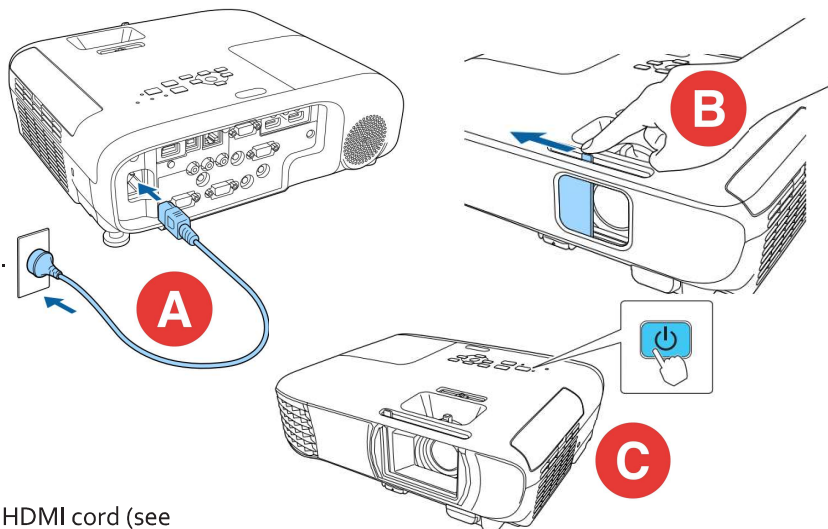

### Connect the Projector

#### Computer Monitor Port:

Connect the computer and the projector with the VGA cable or HDMI cord (see opposite page for more details). If you are using the notecard, switch it to external display. You can also connect an audio cable for sound.

#### Adjust the Image:

1. If you do not see an image, press the source search button on the projector (or remote control to select the image source (Image D).
2. HEIGHT: Raise the image, press the foot release button and lift the front of the projector. Release the button to lock the foot in position (Image E).
3. FOCUS: Turn the focus ring to sharpen the image (Image F).
4. RESIZE: To reduce or enlarge the image turn the zoom ring (Image G).

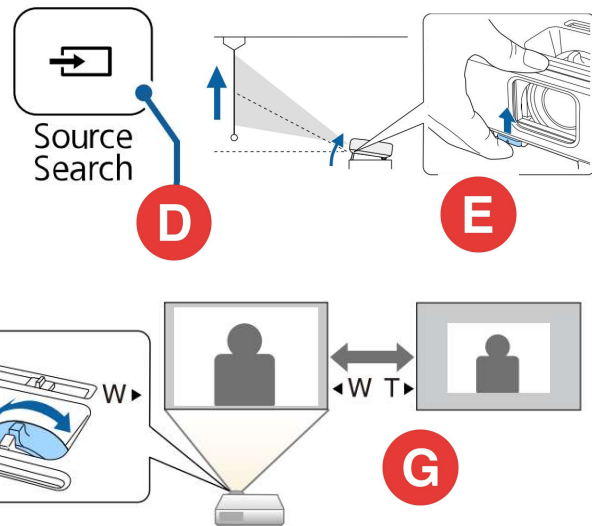

### Kit Includes...

1 Projector



1 VGA Cable



1 Power cord



**NOTE:**

1 Instruction card is included.



\* Remote control, HDMI adapter and other accessories are loaned separately.

# UBC Learning Commons Guides

## Setting up the Video and Audio

### Mac Users

Mac users need the appropriate HDMI or VGA Adapter. If your MAC does not recognize the external display automatically, unplug the HDMI/VGA port, wait for 10 seconds, then plug in again. You might need to turn on "Screen Mirror" on your computer.

### PC Users

PC users need to toggle output to external display using:  
**fn + external display**,  
depending on the model of your laptop  
**fn+F4**, **fn+ F7**, or **fn+ F8**

### Not Sound: HDMI vs VGA

HDMI can transmit audio and visuals at the same time.

VGA cannot transmit audio, just visuals. Hence, audio cable is required.

### Connecting to a Computer for HDMI Video and Audio

1. Connect the HDMI cable
  - a. one end: to your computer's HDMI output port.
  - b. the other end: to the projector's HDMI port.(Image H)

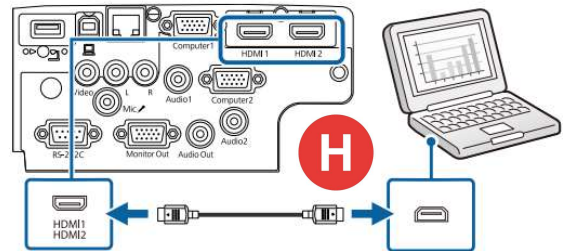

### Connecting to a Computer for VGA Video and Audio

1. Connect the VGA cable
  - a. one end: to your computer's monitor port.
  - b. the other end: to a computer port on the projector.(Image I)
2. Connect the Audio cable
  - a. one end: to your laptop's headphone or audio-out jack, or your desktop's speaker or audio-out port.
  - b. the other end: to the Audio port that corresponds to the Computer port you are using.(Image J)

